

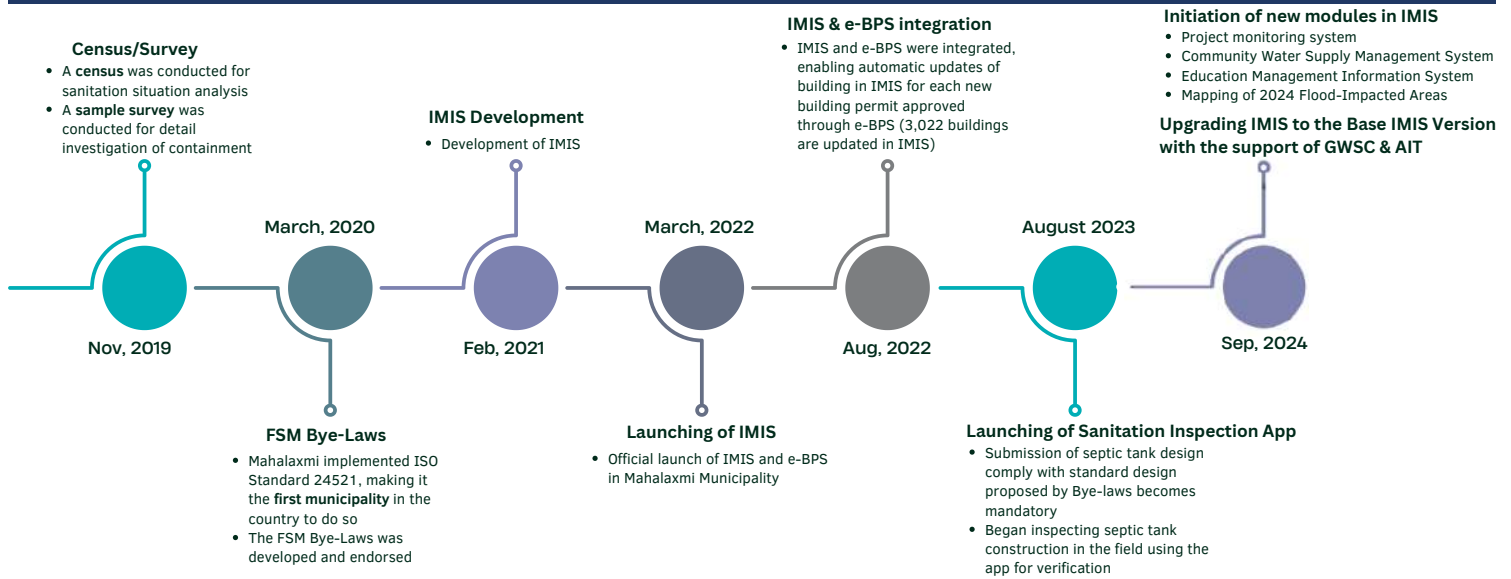

# Implementation of IMIS in Mahalaxmi Municipality and Its Role in Standardizing the Sanitation System (November 2024)



## FSM Bye - Laws      Sanitation Inspection through the Mobile App

### Design of Septic Tank

The design of a septic tank should follow the specifications outlined in the municipal building construction guidelines. A standard septic tank is defined by the following characteristics:

- It should be water-sealed.
- It should have at least two sections and a minimum depth of 1.4 meters.
- The outlet should be connected to a soak-away pit.
- Dimension of septic tank should be designed according to the requirements.
- Septic tank should have manhole for emptying service

Note: Unofficial translation of Section 3, No. 8 (5)

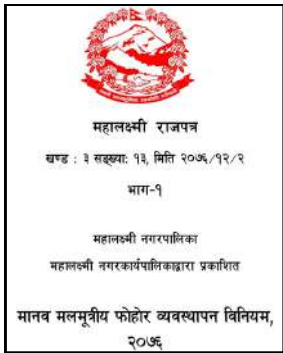

Sanitation inspection		Sanitation inspection	
Checklist questions	Answers		
1. Is the septic tank sealed? (Look for visible leak, cracks and damages)	<input type="radio"/> Yes <input checked="" type="radio"/> No	(First chamber 2/3rd of L and second chamber requirements: 1/3rd of L?)	<input type="radio"/> Yes <input checked="" type="radio"/> No
2. Does the septic have at least two compartments?	<input type="radio"/> Yes <input checked="" type="radio"/> No	8. Is level difference between the inlet and outlet pipe is within 10 cm to 15 cm (i.e., the outlet pipe should be below the invert level of inlet pipe)	<input type="radio"/> Yes <input checked="" type="radio"/> No
3. Is the depth of septic tank within 1.2m and 2.2m? (Please measure the liquid depth, i.e., distance from bottom to lower level of outlet pipe)	<input type="radio"/> Yes <input checked="" type="radio"/> No	9. Are the holes in the partition wall provided is within 10 cm to 15 cm and at the half of liquid depth considered?	<input type="radio"/> Yes <input type="radio"/> No
4. Is Length greater than or equal to the design? Length In design (m):	<input type="radio"/> Yes <input checked="" type="radio"/> No	10. Is the septic tank outlet pipe connected to soak away pits or sewerage network or none?	<input type="radio"/> Yes <input checked="" type="radio"/> No
5. Is Width greater than or equal to the design? Width In design (m):	<input type="radio"/> Yes <input checked="" type="radio"/> No	11. Where is the Septic Tank located? Location according to Design:	<input type="radio"/> Yes <input checked="" type="radio"/> No
6. Is length of septic tank double or more than width of septic tank (L >= 2W) and (L < 5W)	<input type="radio"/> Yes <input checked="" type="radio"/> No	12. Is the septic tank provided with manhole access at inlet and outlet section?	<input type="radio"/> Yes <input checked="" type="radio"/> No
7. Does the septic tank fulfill the chamber length requirements? (First chamber 2/3rd of L and	<input type="radio"/> Yes <input checked="" type="radio"/> No		

### Two-Step Verification process to standardize the sanitation system by integrating it into e-BPS

**Institutionalization of the standardization process in the municipality's building permit process:** The verification of sanitation systems in the field, previously carried out by the Sanitation Cell, is now conducted by the Building Permit Unit.

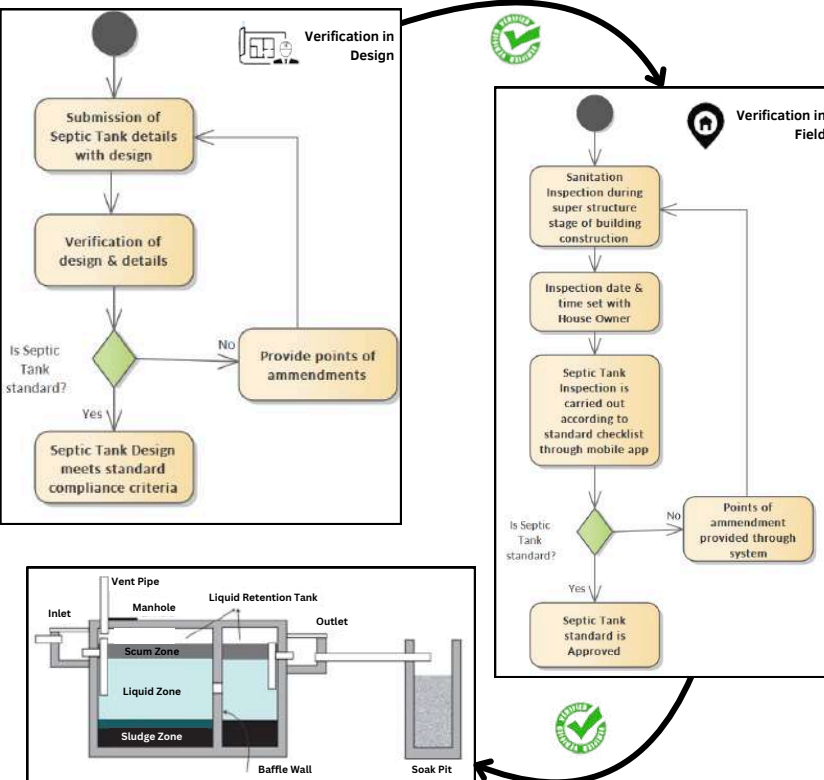

The ISPL team demonstrating the mobile app in the field to the mayor, deputy mayor, chief administrative officer, and building permit chief



# Implementation of IMIS in Mahalaxmi Municipality and Its Role in Standardizing the Sanitation System (November 2024)

## Status and public understanding of sanitation systems before ISO 24521 implementation

The census initially reported that 55.5% of buildings had septic tanks, but a detailed investigation of containment revealed that the actual figure was only 10.75%.

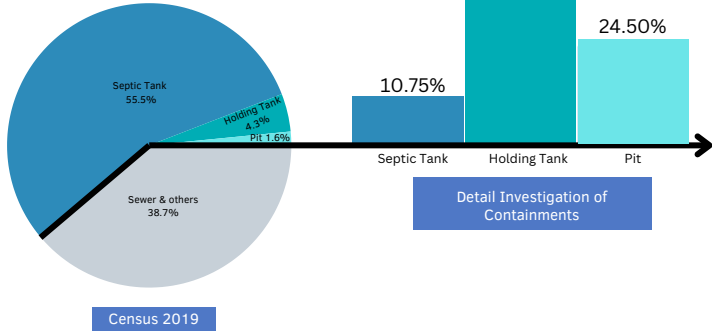

## Building construction permits issued after the integration of IMIS and e-BPS

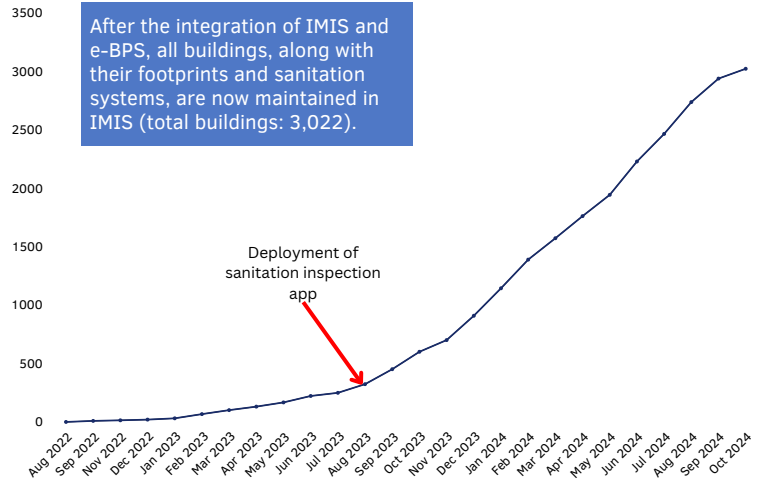

## Trend of Buildings with Standard Septic Tanks

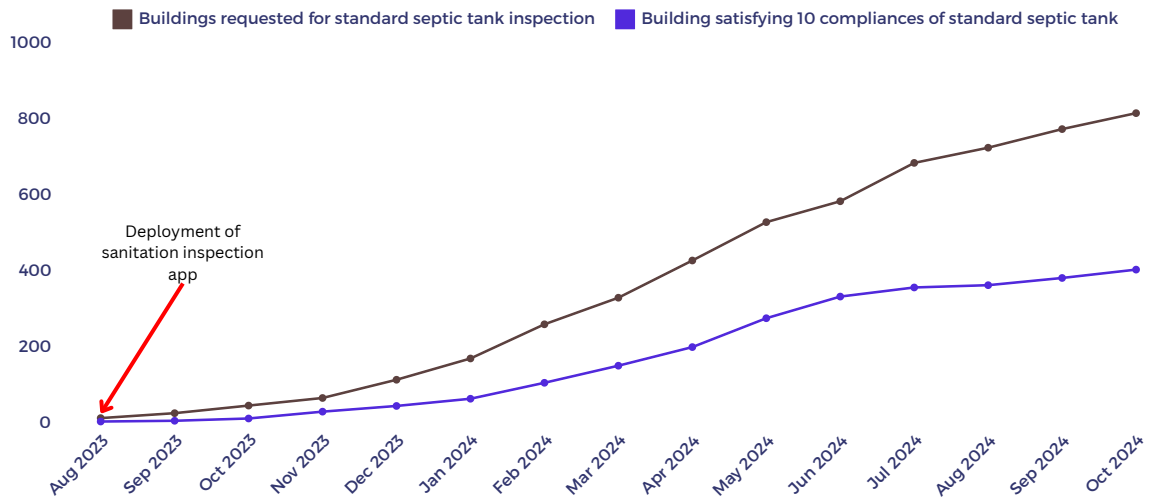

## Buildings satisfying standard Septic Tank compliances

